

FS60 Cavity Slider Installation Instructions

Summary

This document outlines the FS60 fire rated cavity slider.

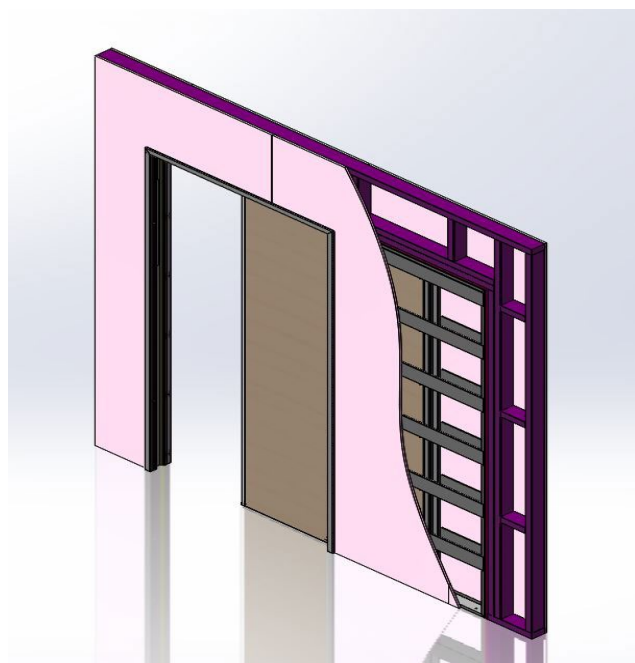

Materials supplied

Door leaf	1 ea	Cavity ladder frame	1 ea
Frame head & jamb (L-frame)	1 ea	Steel frame inserts	2 ea
Cavity frame spacers	2 ea	Steel flametrap	2 ea
Jamb rebate insert	1 ea	Aluminium track	1 ea
Leaf hangers (Rollers)	2 ea	Floor guide	1 ea
Counterweight & pendant	1 ea	Steel wire	1 ea
Roller cut-out cover plates	4 ea	KG1612BW smoke seal	2 ea
Spanner for roller hangers	1 ea	KP3107SS brush seal	4 ea
M5 x 80 mm screws	12 ea	Track mounted stop	1 ea
M5 x 12 mm screws	25 ea		

Tools

Drill driver with pozi & flat driver bits	2.5 mm drill bit
20 mm gib grabbers	Spirit level
Tool to cut 3 mm steel wire	

Procedure

1. Frame out wall opening to o/a frame size + 23 mm (H) / 46 mm (W)
2. Line stud in opening with 13 mm Gib Fyreline
3. Install cavity ladder frame with fasteners to vertical edge only. Don't do up tight, leave room for adjustment.
4. Install L-frame (head and jamb) in line with cavity frame. Frame sections should be touching at the top. Make sure both sections are plumb and square.
5. Install aluminium sliding track. Screw fix through pre-cut holes in steel frame into stud (for steel stud walls, screw into timber blocks above lintel).
6. Insert the hangers into the aluminium track
7. Put the two flame trap sections (folded steel s-shapes) into the back of the cavity frame. These will be screw fixed into the spine of the leaf once it has been hung. They must be placed in the cavity frame before the leaf is hung.
8. Hang the leaf on the hangers. Lay leaf flat on to floor with bottom edge at the frame opening. Check that there are two lines of intumescent seal underneath the leaf before hanging (apply if it is missing). Lift leaf into the vertical position and slot the hangers into the brackets on top of the leaf. Tighten the screws on the hangers to lift the leaf off the floor.

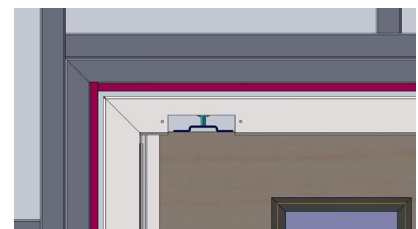
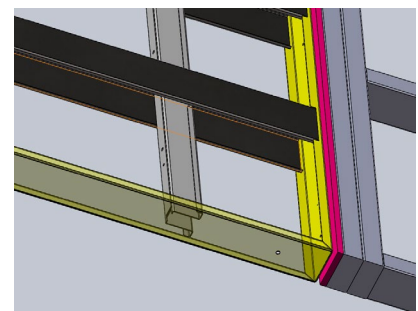
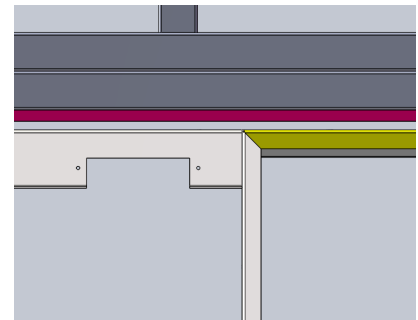
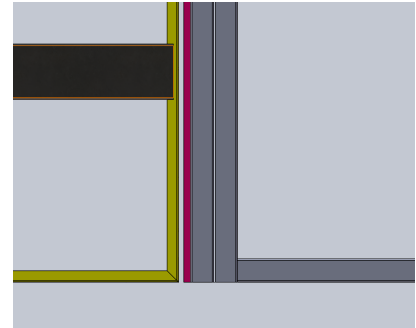

FS60 Cavity Slider Installation Instructions

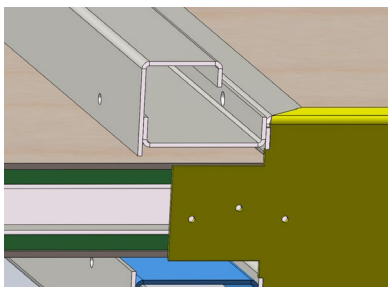
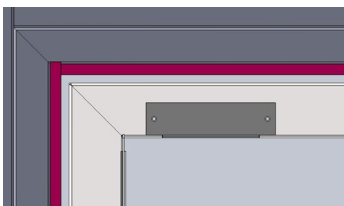
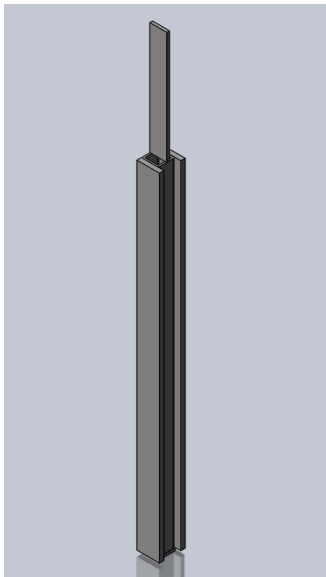
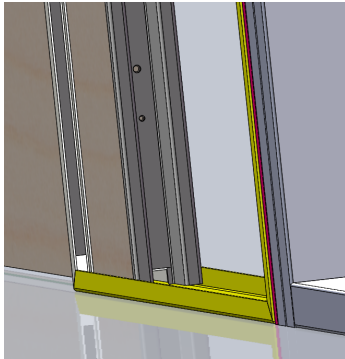

9. Make sure the leaf is running smoothly and that gaps between leaf and frame are even. Once you're happy everything is plumb and square you can drive home all frame fasteners, including top and bottom. Use packers between frame and stud at fixing locations.
10. Adjust hangers to get an even floor clearance of 5-10 mm
11. Screw-fix floor guide to pre-cut holes
12. Fix flame trap sections to trailing edge of leaf with M5 x 12 screws. Small holes are for fasteners, large holes for ventilation.
13. Magclamp (factory fitted inside frame jamb) must be wired to the fire alarm system.
14. Install counterweight. The steel wire goes from the bracket on top of the leaf, through the pulley in the frame, through the hollow counterweight and is connected to the steel pendant. Cut to length so that counterweight hangs off the floor when leaf is in the closed position.
15. Fix hanger cover plates with M5 x 12 mm screws
16. Fix rebate cover plate to vertical (receiving) jamb with M5 x 12 screws
17. Fit frame rear inserts (architrave sections) to both sides. Receiving edge fixes directly to frame jamb with M5 x 12 screws. Trailing edge fixes through frame spacers (C-sections) into cavity ladder frame with M5 x 80 screws. All holes are pre-drilled and tinned.

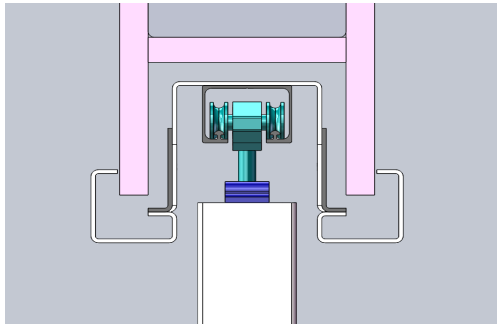

19. At this point the wall lining can be measured and cut. The lining should go up to the back of the rear inserts on all three sides, leaving no more than a 5 mm gap. It may be easier to remove the rear inserts after measuring and putting them back on after the wall has been lined.

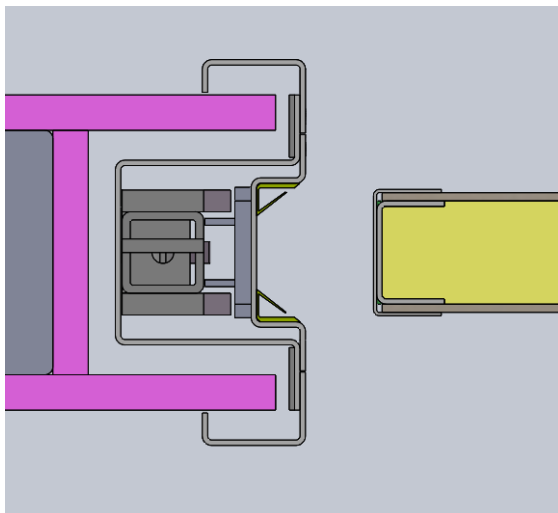

20. The gib lining over the cavity has to be screw fixed to the steel ladder rungs. Pre-drill 2.5 mm holes for 20 mm long gib grabber screws. **DO NOT DRILL OR SCREW IN THIS AREA WHILE THE LEAF IS IN THE CAVITY.** All work should be done with the leaf in the closed position. If 25 mm gib screws are being used you may have to take the tip off to avoid them interfering with the flame trap.

21. The frame can now be painted if required.

22. Once the installation is complete and the jambs have been painted (if applicable) the intumescent smoke seals can be installed.

2 x lengths of KG1612BW fin seals go into the receiving jamb.

KP3107 intumescent brush seals go into the head and cavity side.

